

AggreSand



FEATURES

- 3 Aggregates, 2 Sand, 1 Machine
- Fully Modular
- Fully Automated
- Radio Controlled
- Containerised Transport
- Pre Wired & Pre Plumbed
- 1 Day Set-Up
- 1 Electrical Connection Point
- 1 Water Connection Point

KEY FEATURES

- Fully Modular
- Fully Automated
- Radio Controlled
- Containerised Transport
- Pre Wired & Pre Plumbed
- 1 Day Set-Up
- 1 Electrical Connection Point
- 1 Water Connection Point
- Curved chassis
- Quick set-up time
- Plug and play' electrical points
- Gaps in chassis for wash down

APPLICATIONS

- Virgin Aggregate
- Manufactured Sand
- Sand & Gravel
- Crushed Rock
- Crusher dust
- Scalpings
- Iron ore
- Other mineral ores
- Construction & Demolition Waste Material

OPTIONS

- High capacity sand option (200tph)
- Single sand
- 2 deck

- Automated Radial Sand Stockpilers
- 350m³ (458yds³) Stockpile Per Conveyor

- 3.7m x 1.5m (12'x5') DW Screen
- Twin Sand Product
- High Energy Dewatering Screen Delivering Superior Moisture Reduction

- 4.9m x 1.5m (16'x5') 3 Deck, 2 Bearing Screen
- Isolated Spraybars
- Polyurethane Decks
- Fully Sealed Catchment Tank
- Aggregate Blending Chute
- Service Accessible Rolling Chute

- 1000mm (39") Wide Belt
- Integrated Sealed Washbox
- Raisable Head Section For Screen Access

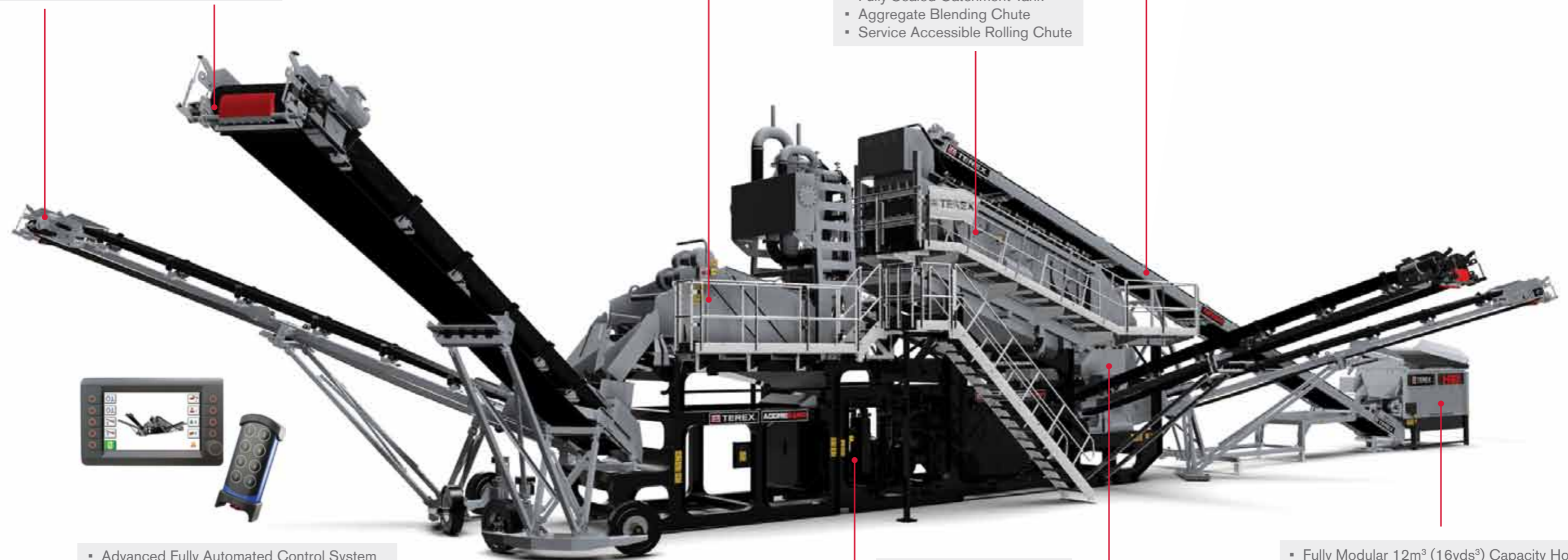

- Advanced Fully Automated Control System With Remote Communication And Radio Control

- Roll-In / Roll-Out Pumps For Easy Maintenance

- Fully Modular 12m³ (16yds³) Capacity Hopper
- Radio Controlled Vibrating & Tipping Grid
- Variable Speed Belt Feeder
- Vibrating Grid Option
- 37kw (50hp) electric hydraulic powerpack

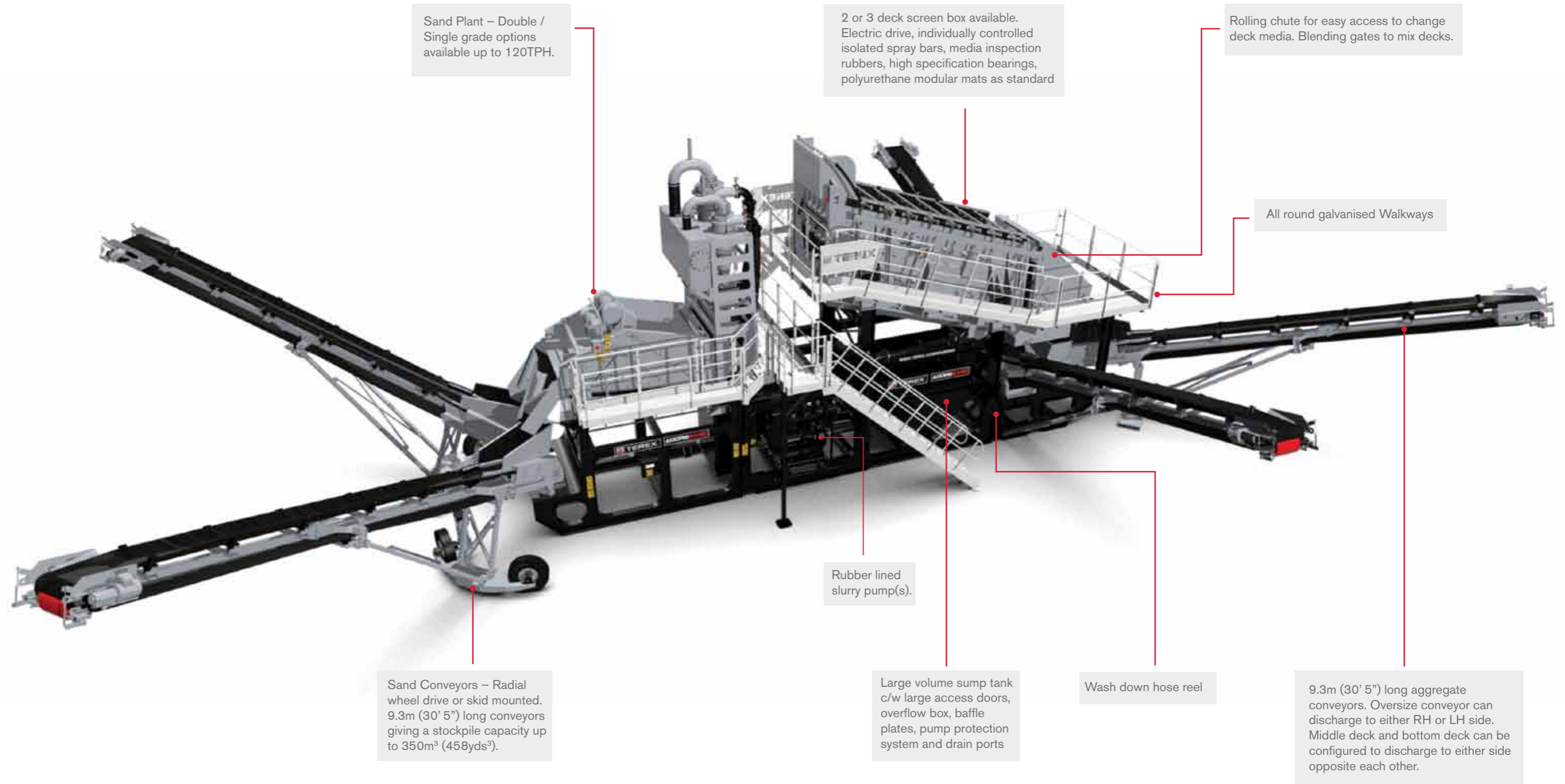

AGGRESAND KEY FEATURES

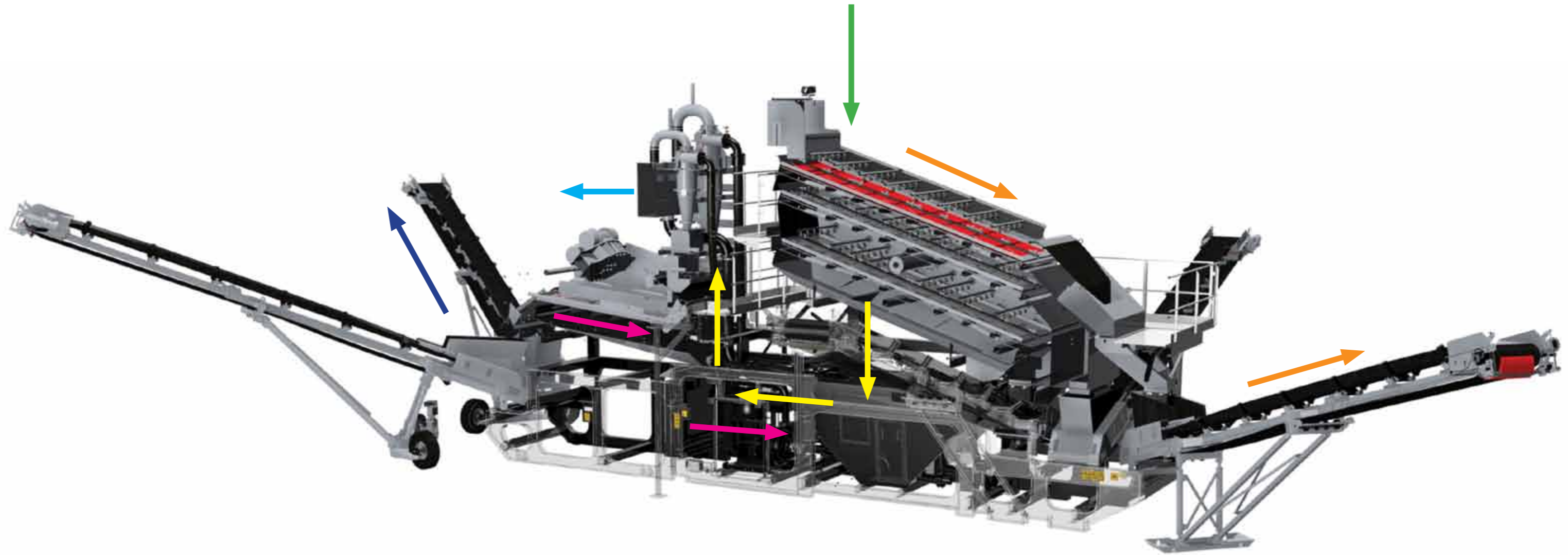

AGGRESAND FLOW



KEY

-  Raw material fed from feed conveyor
-  Washed aggregate for stockpile
-  Slurry (sand & water)
-  Dewatered sand for stockpiling
-  Cyclone overflow to water treatment (water & silt)
-  Dewatering screen underflow back to sump tank

AGGREGATE SCREEN

- 2 or 3 deck Screen box option
- Electrically driven
- Fixed 18 degree working angle
- Spring mounted
- Enclosed rubber lined wash box complete with independently controlled spray bar
- 8 independently controlled isolated spray bars per deck complete with fan tail plastic nozzles
- Polyurethane modular decks as standard (mesh deck option)
- Lined rolling chute arrangement complete with blending capabilities
- Rubber lined catch box (complete with 1/3-2/3 rubber lined division plate for dual sand models)
- Rubber lined discharge chutes
- Pressure clock on manifold
- Inspection flaps to view screen media



CENTRE CHASSIS

- Rubber lined slurry pump(s) situated upon roll out maintenance platforms
- Ceramic lined bends
- One point water feed
- Pre-wired control panel with external HMI panel
- Large volume sump tank
- Plant wash down hose on retractable reel
- Split tank for double grade (double grade only)
- Float on coarse side of tank (double grade only)
- Letterbox on divider plate to keep tank levels equal (double grade only)
- Overflow box
- Large inspection doors (both sides on double grade)
- Tank drain (both sides on double grade)
- Anti-turbulence baffle plates
- Replaceable rubber lined wear plates on feed area



SAND PLANT

- High energy 3.7m x1.5m (12'x5') Dewatering screen – dewatering up to 120TPH of sand
- Polyurethane modules and side protection bars
- Moulded central division plate (double grade only)
- Rubber lined cyclones
- Ceramic lined inlet bends
- Rubber lined underflow boxes - c/w quick release lid
- Rubber lined blending box - c/w quick release lid (double grade only)
- 5.5m (18') dirty water discharge height
- Rubber lined catch box for screen underflow
- Spray bar in catch box
- Polyethylene wear board in discharge chute
- Adjustable discharge blending chute – double grade only
- Pressure gauge to monitor cyclone inlet pressure
- High specification cyclone inlet hoses c/w flanges



AGGREGATE CONVEYORS

- Reconfigurable Conveyors
- Plain 26" (660mm) wide belt
- 18 degree angle
- SCS tear drop scraper (option)
- Direct drive electric gearbox
- 9.3m (30' 5") long
- 4.1m (13' 5") discharge height
- 3 deck oversize conveyor can discharge to right or left side

SAND CONVEYORS

- Rigid – folded for transport
- Radial – skid mounted as standard
- Radial – wheel drive option
- Plain 26" (660mm) wide belt
- 20° angle
- SCS tear drop scraper (option)
- Direct drive electric gearbox
- 9.3m (30' 5") long
- 4.9m (16' 1") discharge height



WALKWAYS

- Galvanised
- Walkway round both sides of machine
- Expanded metal walkway floors
- Curved ends on handrails
- 600mm (24") wide

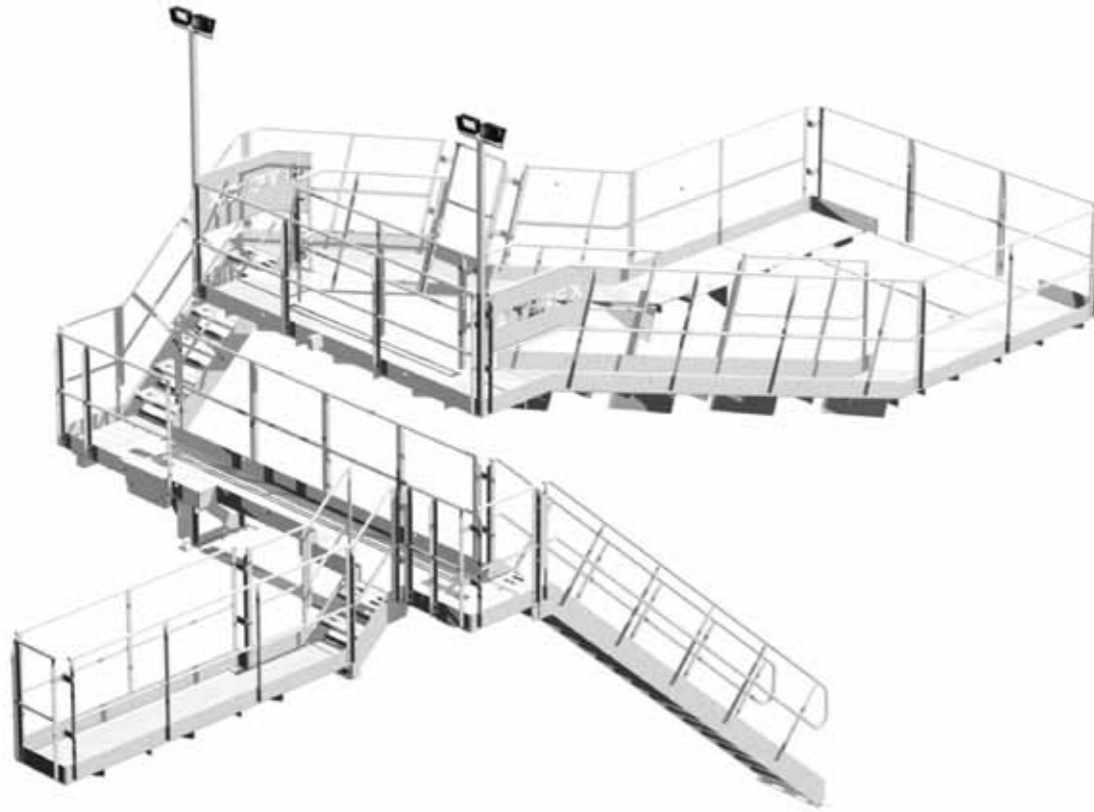

CONTROL SYSTEM

- Robust full color graphic HMI (Human Machine Interface)
- Automated Start / Stop sequence of all plant items
- Automated sequence shutdown on fault detection
- On-screen display of all key Parameters inc:
 - Inlet water Flow
 - Cyclone pressure
 - Hydraulic oil level and temperature
 - All motors load currents and voltages
- Radio control of
 - Plant Start / Stop
 - Feeder Start / Stop
 - Sand Conveyor Radial Drive
 - Tipping Grid Raise / Lower
 - Plant Lighting On / Off



OPTIONS

- Telemetry System with remote communication of all alarms and status such as TPH via text message and / or email (can be tailored to exact requirements)

FEED SYSTEM (OPTIONAL)

HOPPER

| | | |
|--------------|------------------|-----------------------|
| CAPACITY | 12m ³ | (16yds ³) |
| GRID SPACING | 100mm | (4") |

2 DECK VIBRATING GRID

| | |
|---------------|----------|
| WORKING ANGLE | 10-20° |
| TIPPING ANGLE | 45° max |
| MOTOR | 59cc/rev |

POWERPACK

| | | |
|--|------|--------|
| OPTION 1 POWER REQUIREMENTS (FEEDER ONLY) | 37kW | (50hp) |
| OPTION 2 POWER REQUIREMENTS (FEEDER/RADIO TIPPING) | 37kW | (50hp) |
| OPTION 3 POWER REQUIREMENTS (LIVE HEAD/FEEDER/RADIO TIPPING) | 37kW | (50hp) |

FEED CONVEYOR

| | | |
|----------------|--------|----------|
| LENGTH | 18.7m | (61' 4") |
| BELT | 1000mm | (39") |
| POWER REQUIRED | 11Kw | (15hp) |

TECHNICAL INFORMATION

| SCREEN BOX | 2 SAND, 2 AGG | 2 SAND, 3 AGG | 1 SAND, 2 AGG | 1 SAND, 3 AGG |
|---------------------------------------|--|--|--|--|
| SCREENING AREA | 4.9x1.5m (16'x5") | 4.9x1.5m (16'x5") | 4.9x1.5m (16'x5") | 4.9x1.5m (16'x5") |
| NUMBER OF DECKS | 2 | 3 | 2 | 3 |
| POWER REQUIRED | 15kW (20hp) | 15kW (20hp) | 15kW (20hp) | 15kW (20hp) |
| MOUNTING | Spring | Spring | Spring | Spring |
| SCREEN BEARINGS | 2 bearing | 2 bearing | 2 bearing | 2 bearing |
| MAX SPRAYBAR WATER THROUGHPUT @ 2 BAR | 235m ³ /hr (307yds ³) | 340m ³ /hr (445yds ³) | 235m ³ /hr (307yds ³) | 340m ³ /hr (445yds ³) |
| DEWATERING SCREEN | 3.7x1.5m (12'x5") | 3.7x1.5m (12'x5") | 3.7x1.5m (12'x5") | 3.7x1.5m (12'x5") |
| DEWATERING SCREEN POWER REQUIRED | 8KW (10HP) | 8KW (10HP) | 8KW (10HP) | 8KW (10HP) |
| FINES PUMP | 150/125 - 15kW | 150/125 - 15kW | | |
| COARSE PUMP | 200/150 - 22kW | 200/150 - 22kW | 200/150 - 30kW | 200/150 - 30kW |

SAND PLANT

STOCKPILE CONVEYORS

| QUANTITY | 4 | 5 | 3 | 4 |
|--------------------------------|---|---|---|---|
| LENGTH | 9.3m (30' 5") | 9.3m (30' 5") | 9.3m (30' 5") | 9.3m (30' 5") |
| BELT WIDTH | 650mm (26") | 650mm (26") | 650mm (26") | 650mm (26") |
| BELT TYPE | 650mm EP315 3 ply plain x 3+1.5 covers | 650mm EP315 3 ply plain x 3+1.5 covers | 650mm EP315 3 ply plain x 3+1.5 covers | 650mm EP315 3 ply plain x 3+1.5 covers |
| STOCKPILE CAPACITY - SAND | 350m ³ (458yds ³) (per conveyor) | 350m ³ (458yds ³) (per conveyor) | 800m ³ (1046yds ³) | 800m ³ (1046yds ³) |
| STOCKPILE CAPACITY - AGGREGATE | 100m ³ (131yds ³) | 100m ³ (131yds ³) | 100m ³ (131yds ³) | 100m ³ (131yds ³) |
| POWER REQUIRED | 4kW (5hp) x 4 | 4kW (5hp) x 5 | 4kW (5hp) x 3 | 4kW (5hp) x 4 |
| WHEEL DRIVE POWER REQUIREMENTS | 0.37kW (0.5hp) | 0.37kW (0.5hp) | 0.37kW (0.5hp) | 0.37kW (0.5hp) |

POWER AND WATER REQUIREMENT

| | | | | |
|---------------------------|---|---|---|---|
| MAXIMUM POWER REQUIREMENT | 125.74kW (166.29hp) | 128.74kW (172.64hp) | 113.37kW (152.03hp) | 117.37kW (157.40hp) |
| AVERAGE WATER REQUIREMENT | 250m ³ /hr (327yds ³ /hr) | 250m ³ /hr (327yds ³ /hr) | 250m ³ /hr (327yds ³ /hr) | 250m ³ /hr (327yds ³ /hr) |

DIMENSIONS

WORKING DIMENSIONS (WITHOUT FEED SYSTEM)

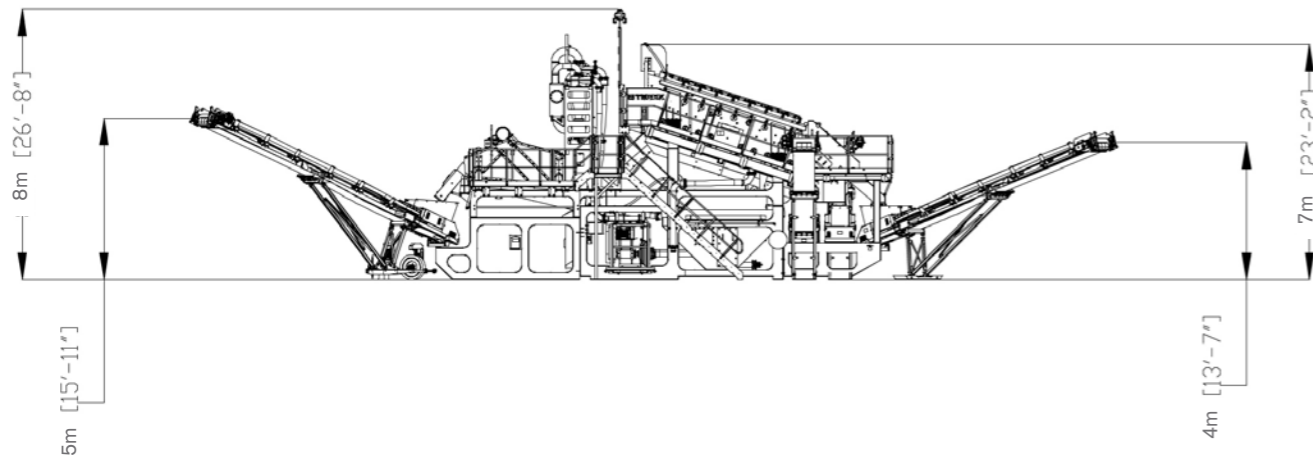
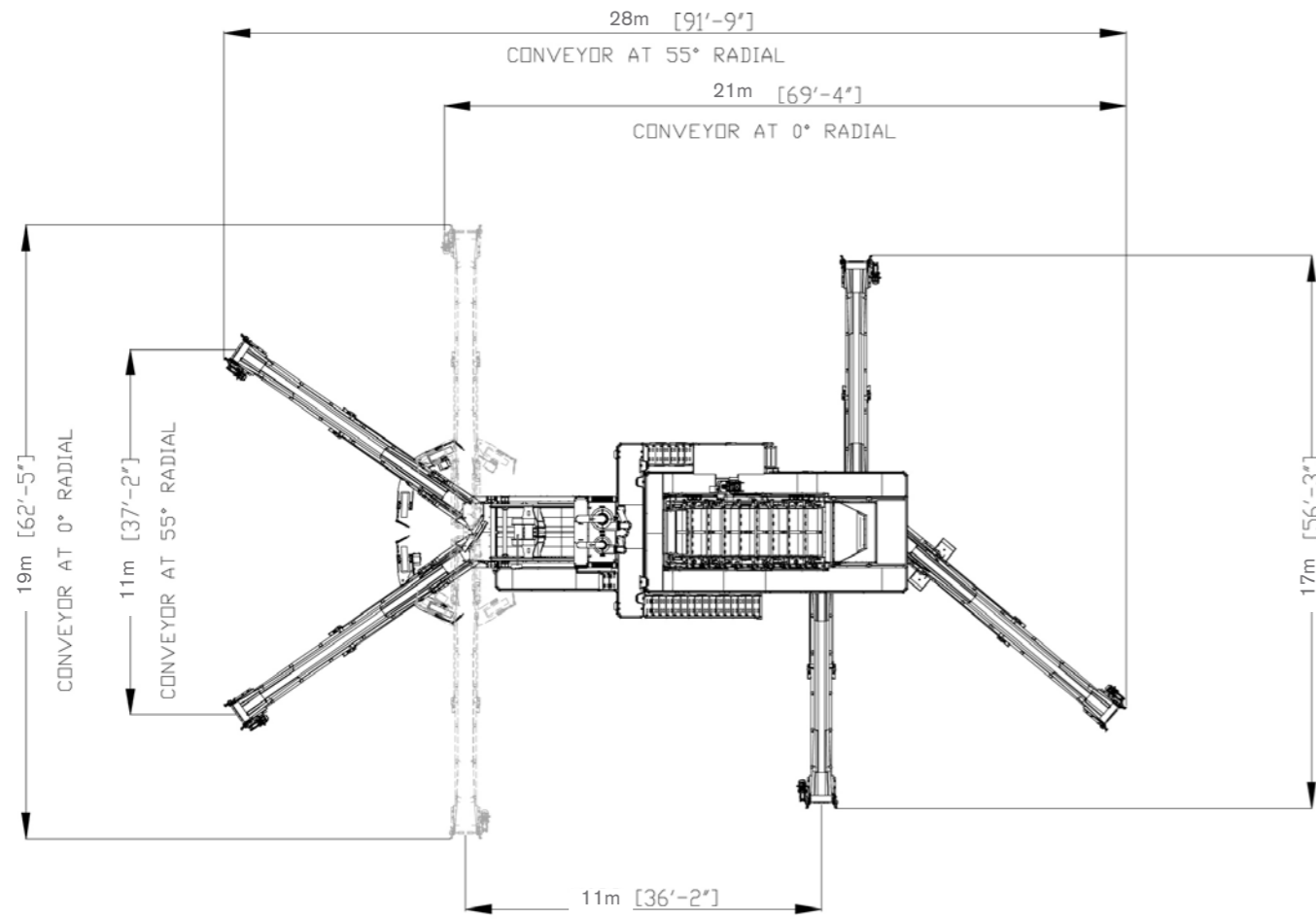

WORKING DIMENSIONS (WITH FEED SYSTEM)

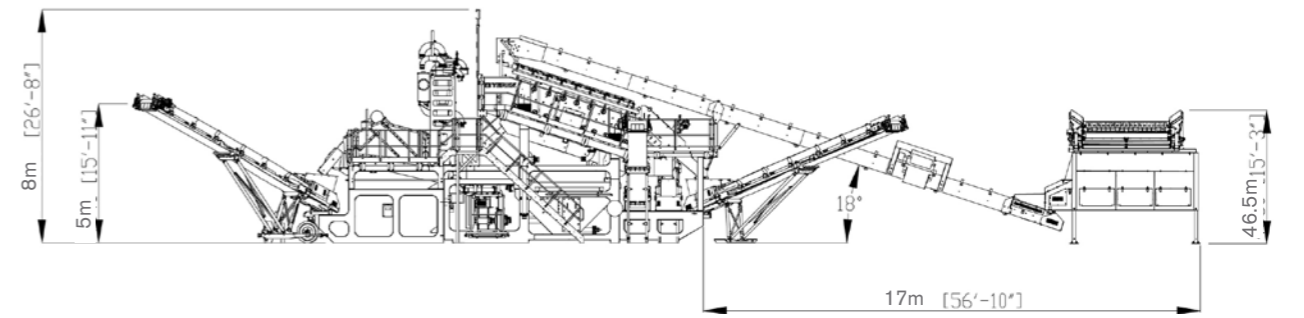
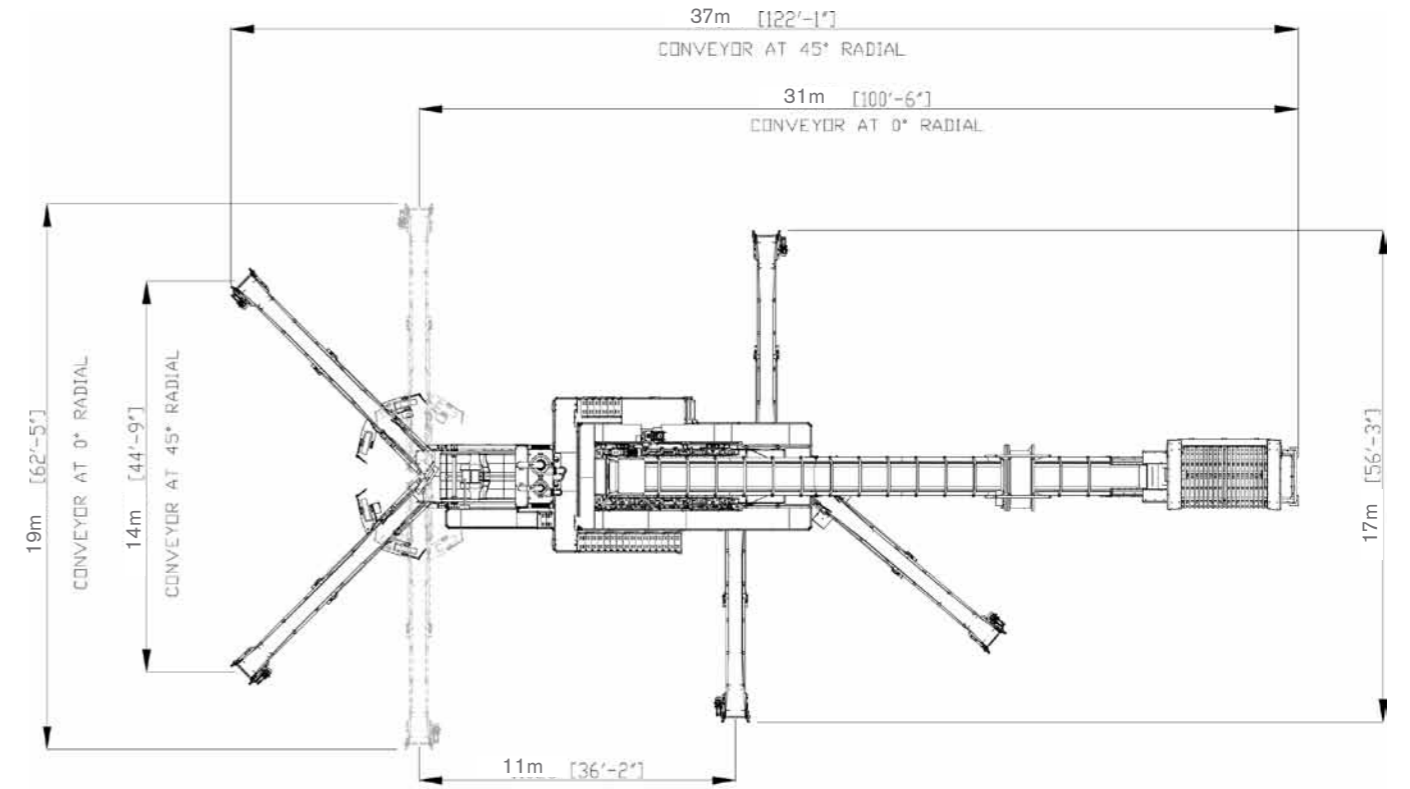

AGGRESAND PLINTH

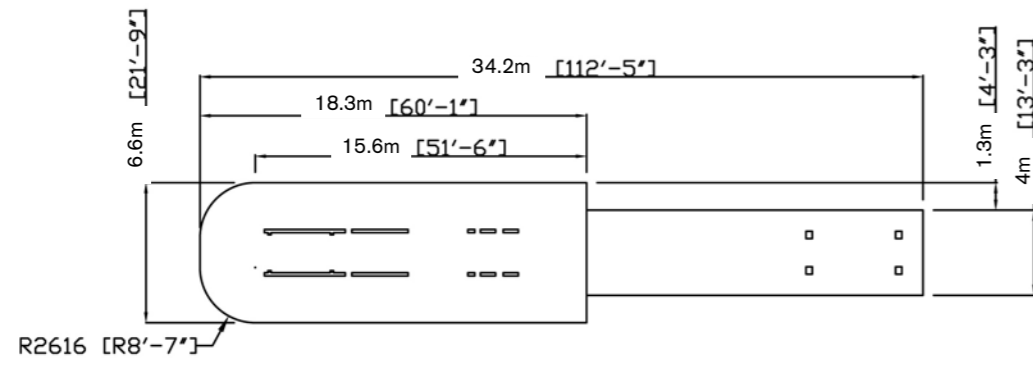
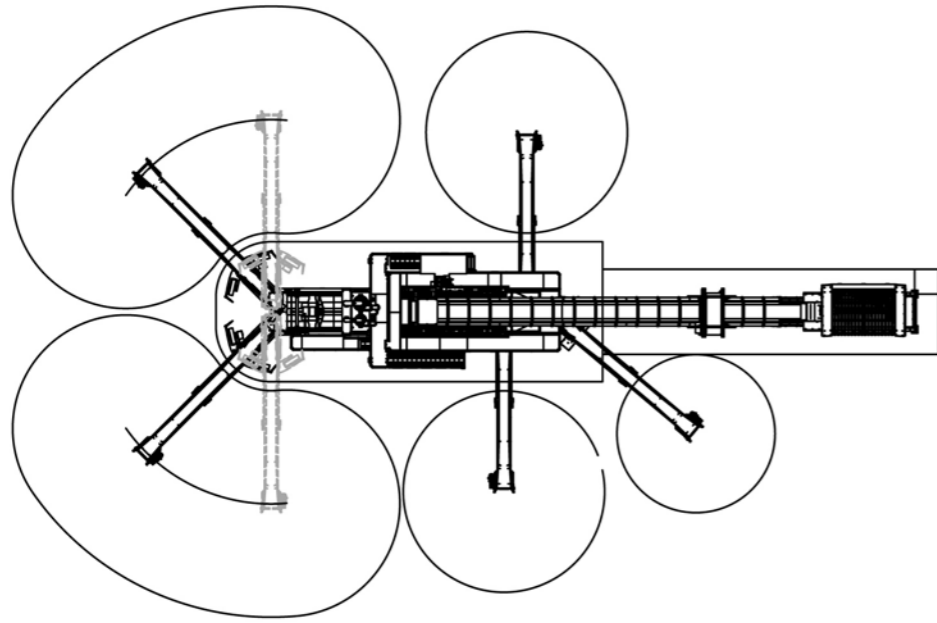

AGGRESAND FOOTPRINT

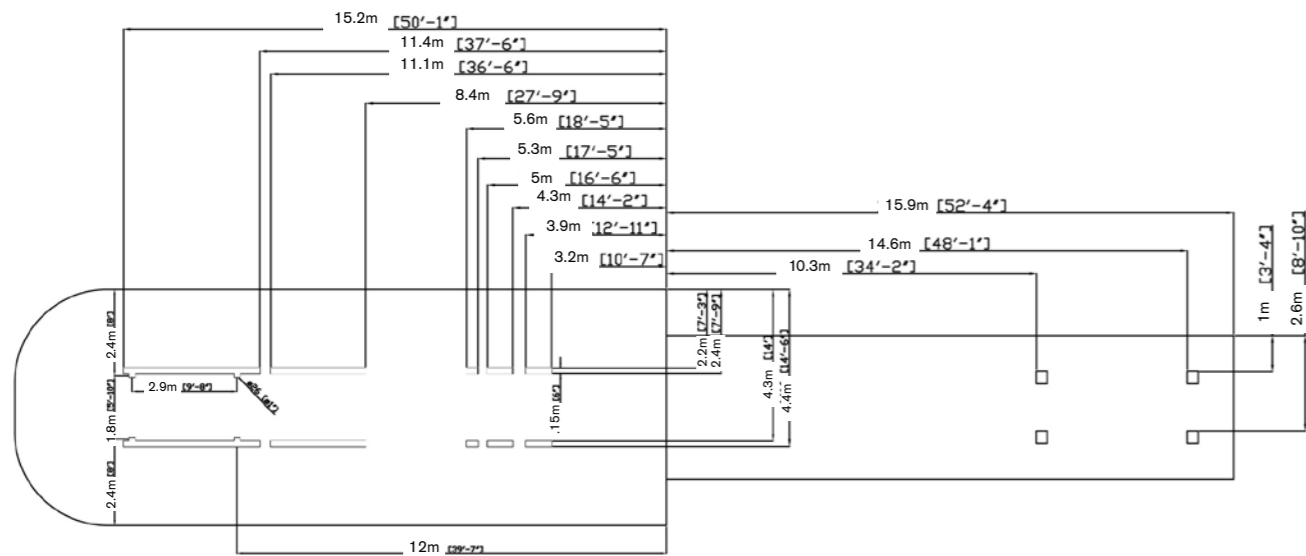

AGGRESAND

| | |
|--|--|
| STATIC WEIGHT OF MACHINE ON FOOT PRINT (EMPTY) | 40,500kg |
| DYNAMIC WEIGHT OF MACHINE ON FOOT PRINT (FULL) | 52,200kg ±802kg (Vertical) ±401kg (Horizontal) |

TRANSPORT CONTAINERS

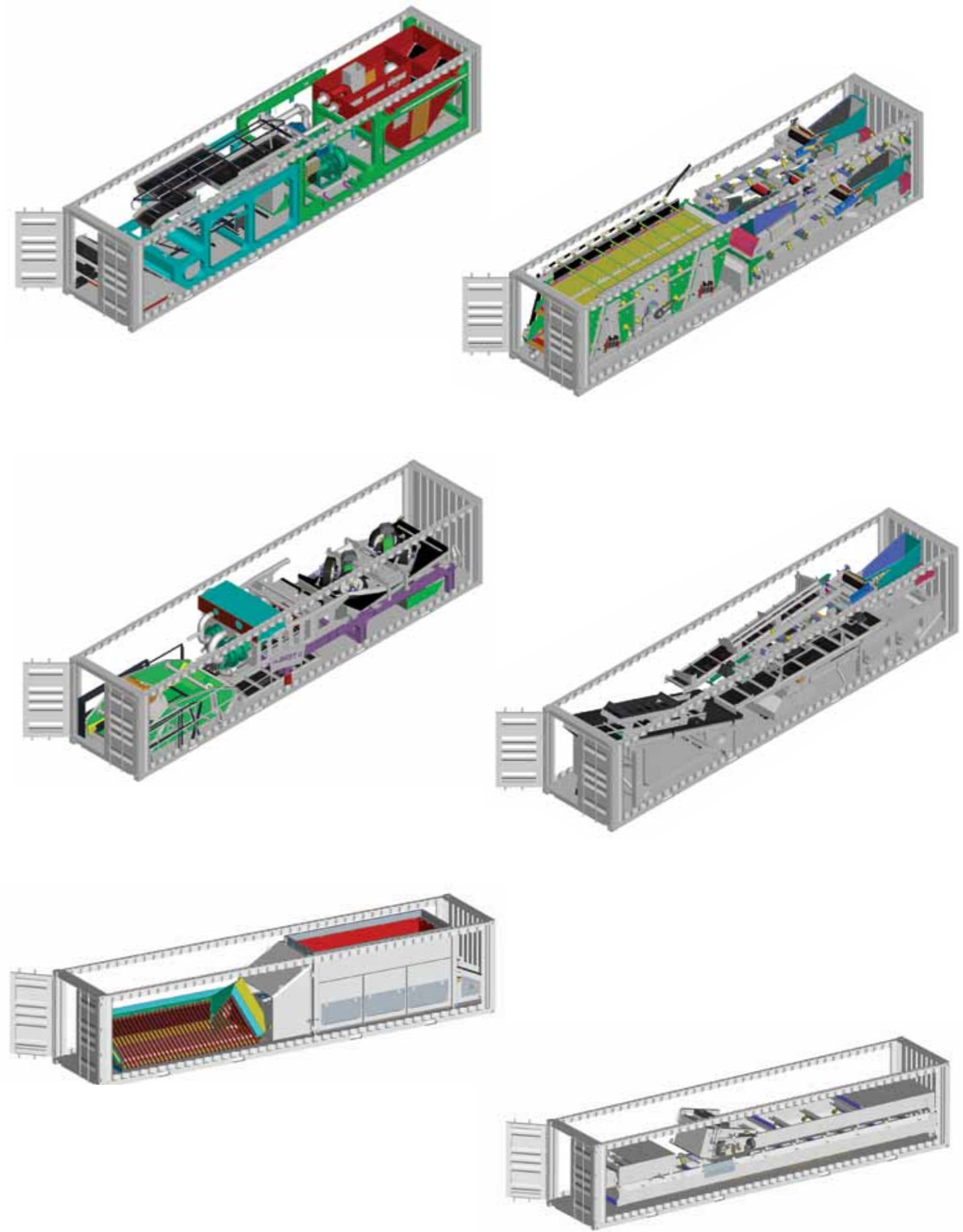

TEREX WASHING SYSTEMS CONTACT DETAILS

Dungannon Site

200 Coalisland Road

Dungannon

Co. Tyrone

Northern Ireland

BT71 4DR

Tel: +44(0) 28 8771 8500

Email: TWS.sales@terex.com

www.terex.com/washing

YouTube

Check out Terex Washing Systems videos

on YouTube: www.youtube.com/terexwashingsystems



www.facebook.com/TerexCorporation

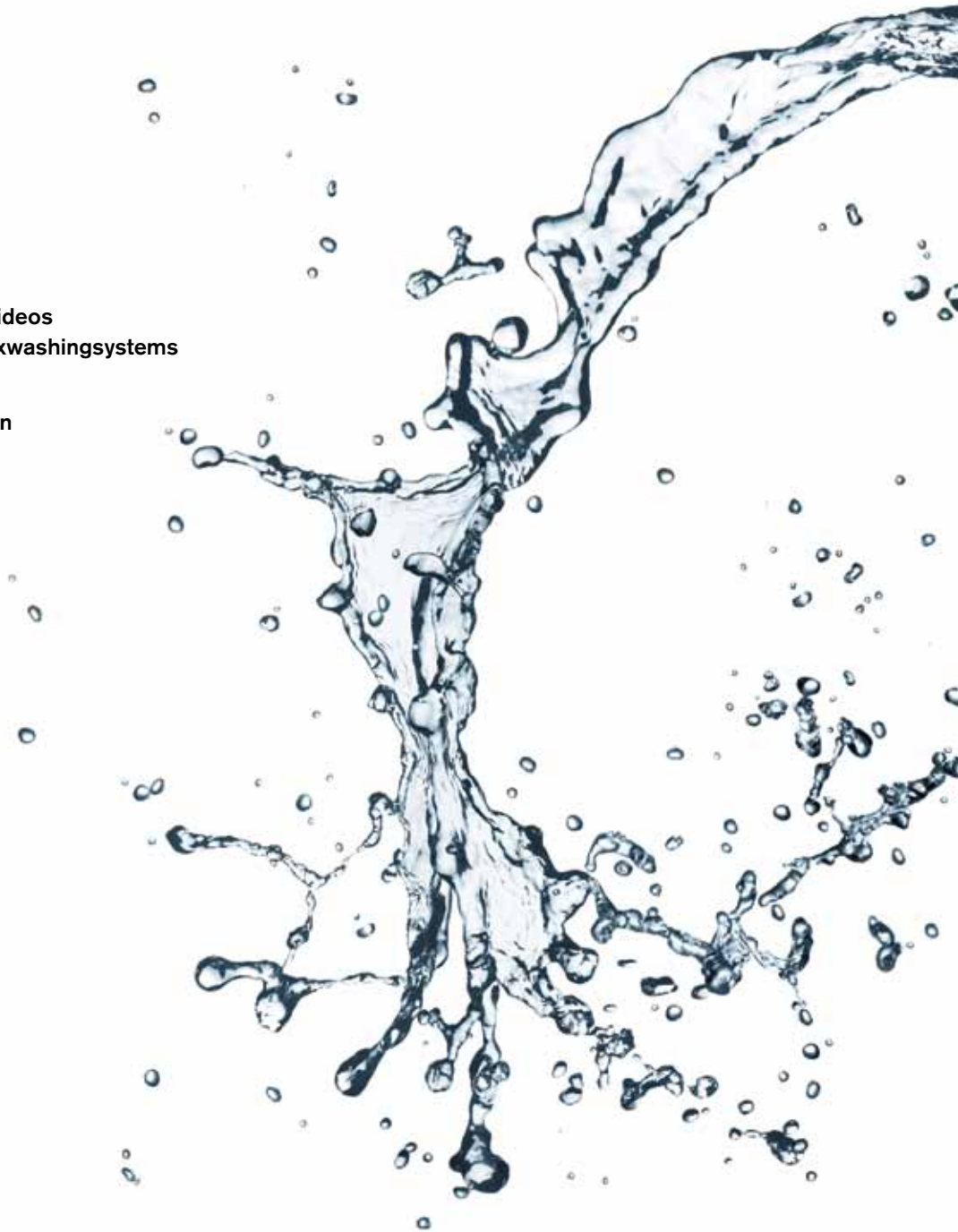

Effective Date: April 2013 Product specifications and prices are subject to change without notice or obligation. The photographs and/or drawings in this document are for illustrative purposes only. Refer to the appropriate Operator's Manual for instructions on the proper use of this equipment. Failure to follow the appropriate Operator's Manual when using our equipment or to otherwise act irresponsibly may result in serious injury or death. The only warranty applicable to our equipment is the standard written warranty applicable to the particular product and sale and Terex makes no other warranty, express or implied. Products and services listed may be trademarks, service marks, or trade names of Terex Corporation and/or its subsidiaries in the USA and other countries. All rights are reserved. Terex is a registered trademark of Terex Corporation in the USA and many other countries. © 2010 Terex Corporation.



WORKS FOR YOU.™